

# Workbench adapter (bar clamps)

Clamping elements for workbenches



BESSEY® provides solutions for fixing workpieces to workbenches. Use the TWV and TW clamping elements in conjunction with one of the workbench adapters on a workbench.

## 1 NEW adapters for workbenches

BESSEY® TWV and TW clamping elements with a 16 mm hole system can be used on wooden workbenches using an easy-to-use adapter. Put the 16mm TW/TWV clamp into the adapter and place into the table hole. See chart below for configurations.

## 2 Flexible or fixed throat depth

Adjustable throat depth (TWV) and fixed throat depth (TW) are available in 3 handle variants.

## 3 Handle variants

The ratchet mechanism ensures rapid, controlled, vibration-free clamping. The T-Bar versions and more traditional 2K handle offer excellent options for the end user.



## Workbench adapter, 16 mm

Accessories for BESSEY® TWV and TW clamping elements with 16 mm hole system. Suitable for common workbenches with a hole system (see below). Can be used without tools. The stud pin can be changed to use other hole systems.

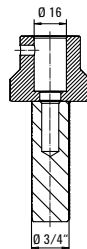

	Clamp Hole Diameter	Workbench Hole Diameter	Approx. Weight
<b>TW16AW19</b>	16 mm	3/4"	0.82 lbs
<b>TW16AW20</b>	16 mm	29/32"	0.85 lbs
<b>TW16AW25</b>	16 mm	1"	0.90 lbs
<b>TW16AW30</b>	16 mm	1 1/64"	0.95 lbs

